



ASSEMBLY INSTRUCTIONS & USER MANUAL

300' Hose Reel Cart - Flat-Free wheels

LS1-060



Package Contents:

Make sure all parts are present and place them side by side for easy identification

ASSEMBLY INSTRUCTIONS

1. (SEE FIGURE 1) Place Frame (A1) into Frame (A2), and Then attach two Support Brackets(K) on both side Frame(A1&A2), and fix them with two sets of Bolts(6), Flat washers(12)and Lock nuts(11).

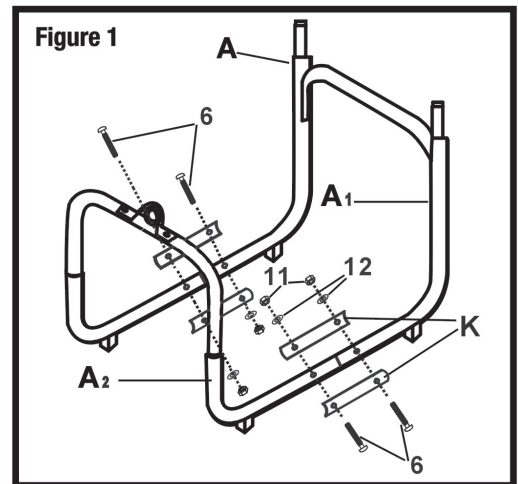

2. (SEE FIGURE2) Remove and retain lock nut (9) and flat washer(10) from axle (B). Stand frame assembly (A) upright. Slide each axle (B) through both ends of frame (A).

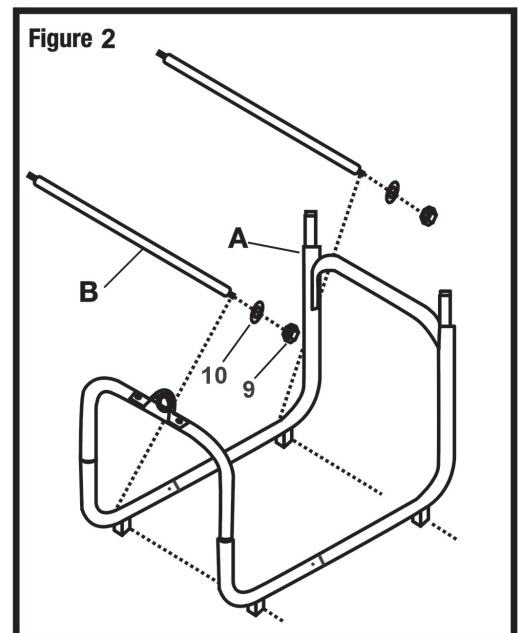

3. (SEE FIGURE3) Slide wheels (C) onto ends of each axles (B), with the wheel valve stems facing outward. Fasten each wheel to axle using flat washers(10) and lock nuts (9). Do not over tighten.

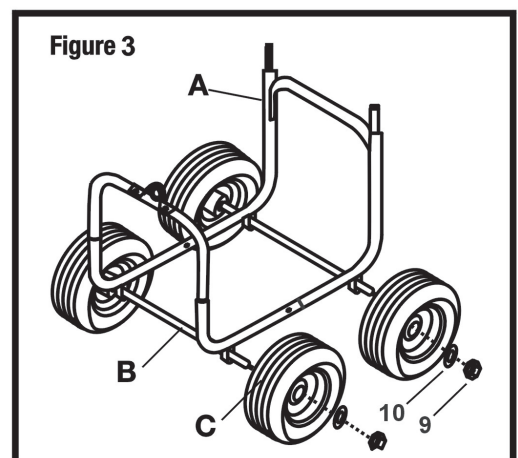

4. (SEE FIGURE 4) Insert the end of crank handle (E) through crank hub of frame (A).

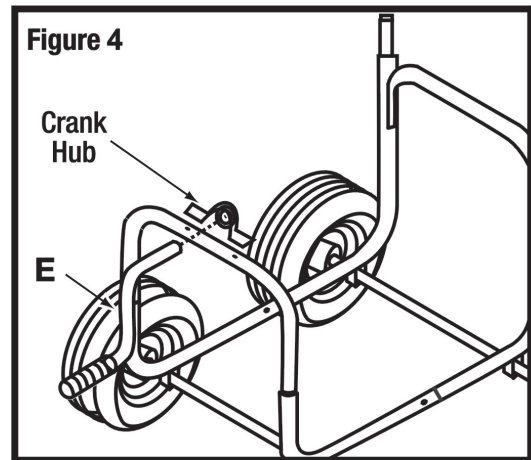

5. (SEE FIGURES) Attach the first hose reel (D) to the roller (I), on the end with the crank handle stem, using 6 bolts (5). On the opposite end of the roller (I), insert the watercoupling (J) into the center hole of the reel and roller. Place the U bracket (13) over the tubing of the water coupling (J). Use 7 bolts (5) to attach the U bracket, water coupling and reel to the roller.

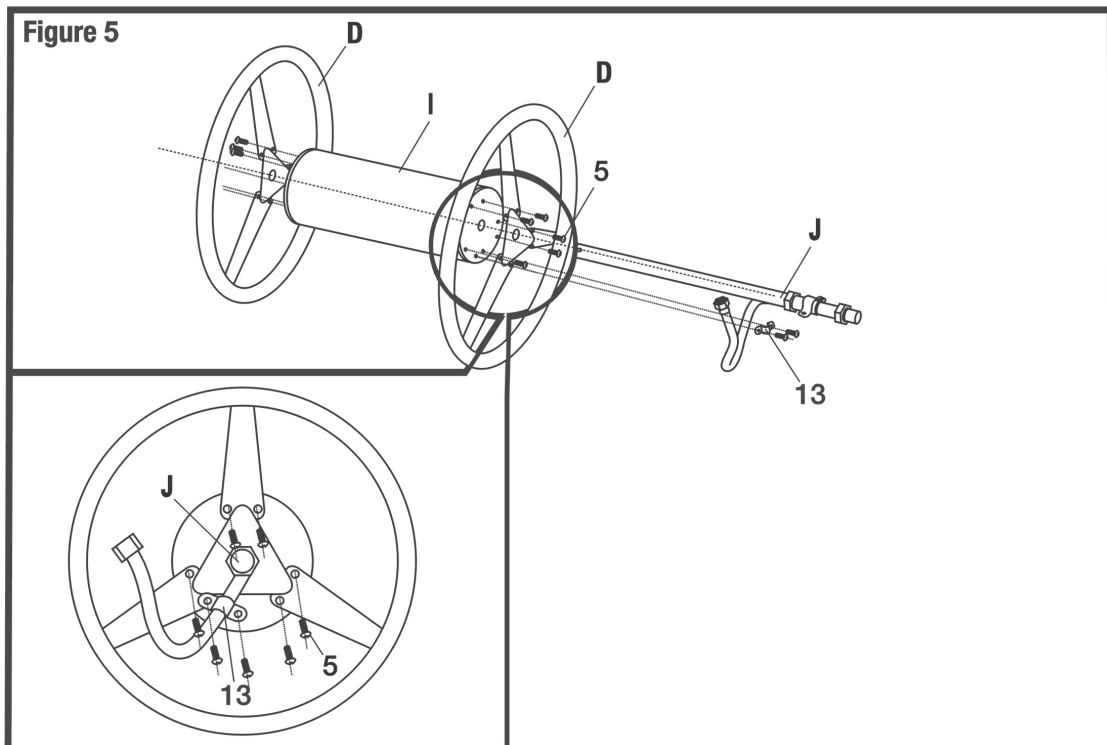

6. (SEE FIGURE 6) Place hose reel (D) into frame assembly (A). Insert end of crank stem from hose reel (D) onto crank handle (E). Align crank handle (E) mounting holes with crank stem mounting holes.

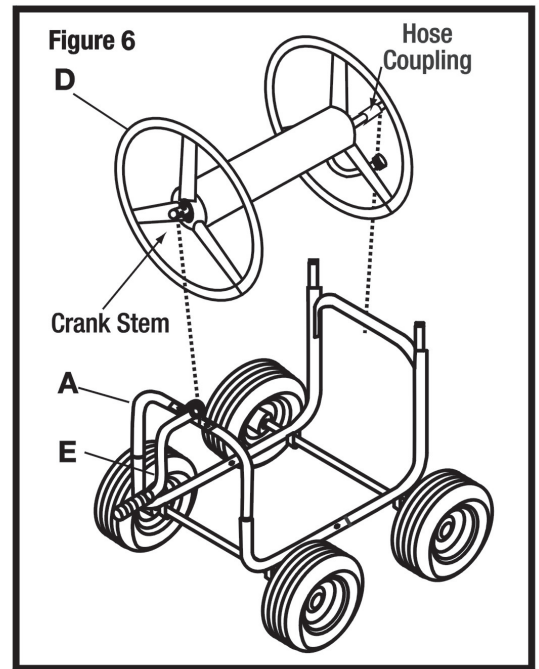

7. (SEE FIGURE 7) Insert bolt (3) through inside hole of crank stem and crank handle hole. Place flat washer (10) onto bolt (3) fasten with lock nut (11). Insert bolt (3) through outside hole of crank stem and crank handle hole and fasten with lock nut (11). Tighten all fasteners securely.

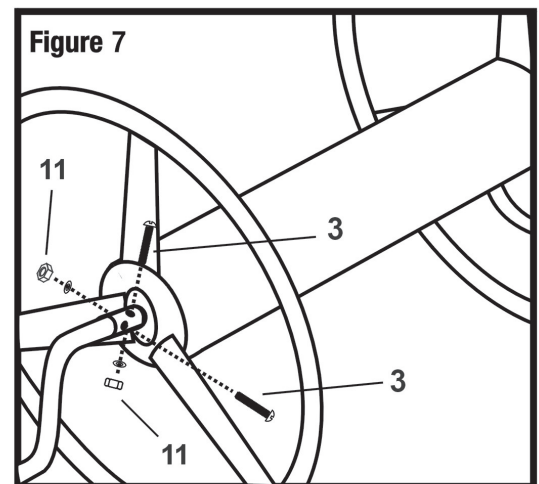

8. (SEE FIGURE 8) Attach hose coupling end of hose reel (D) to frame (A), using U-Bracket. Fasten U-bracket to frame with carriage bolts (I) and lock nuts (11). Tighten securely.

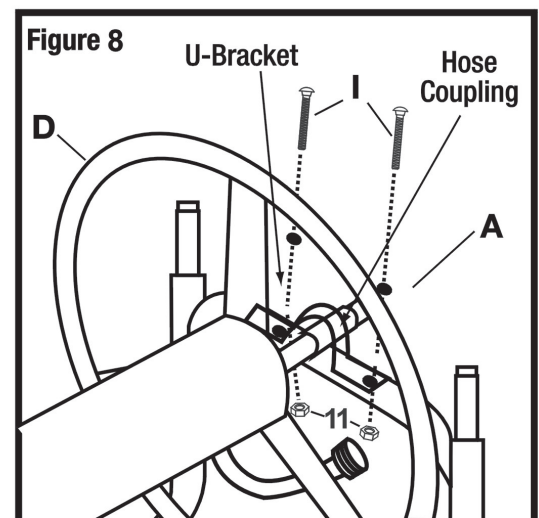

9. (SEE FIGURE 9) Place handle (F) onto vertical posts of frame (A). Align mounting holes. Slide bolt (2) through mounting holes and place flat washer (12) onto bolt (2). Fasten handle (F) using lock nut (11).

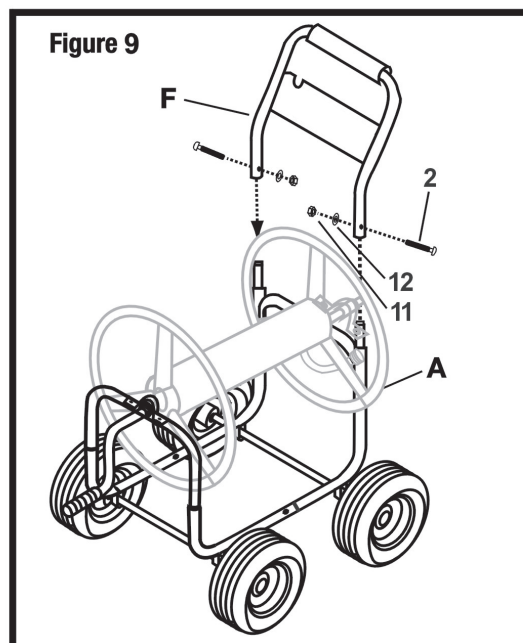

10. (SEE FIGURE 10) Attach basket (H) to handle (F). Place flat washer (8) onto bolt (4) and slide both bolts through mounting holes of handle (F). Place basket (H) mounting tabs onto bolts (4) then place flat washer (8) onto both bolts. Fasten basket using hex nuts (7).

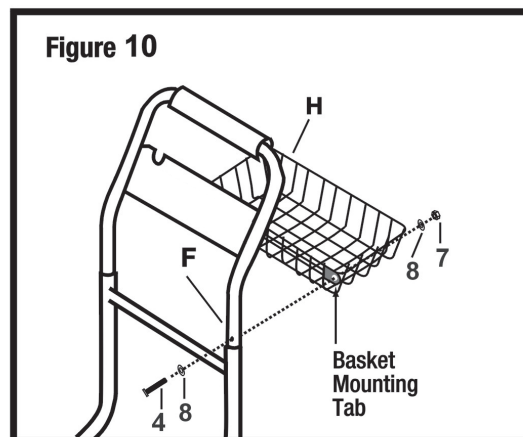

11. (SEE FIGURE 11) Place rubber washer (14) into female end of water coupling on hose reel (D) drum. Attach one end of leader hose (G) to water coupling on hose reel (D) drum. Attach the other end of leader hose (G) to the water supply spigot. Attach garden hose to threaded garden hose connector and wind garden hose around hose reel (D). NOTE: The hose reel will hold up to 300' of 5/8" garden hose. (Garden Hose Not Included)

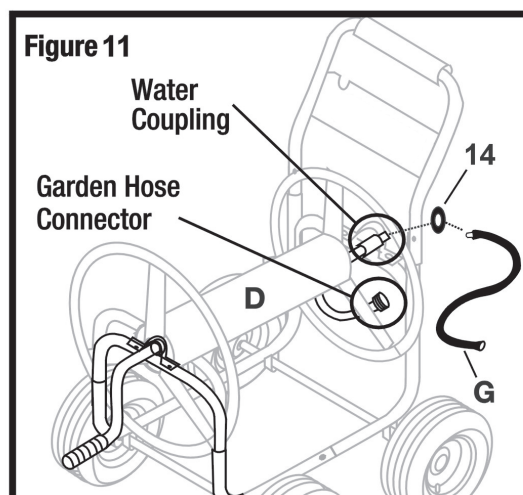
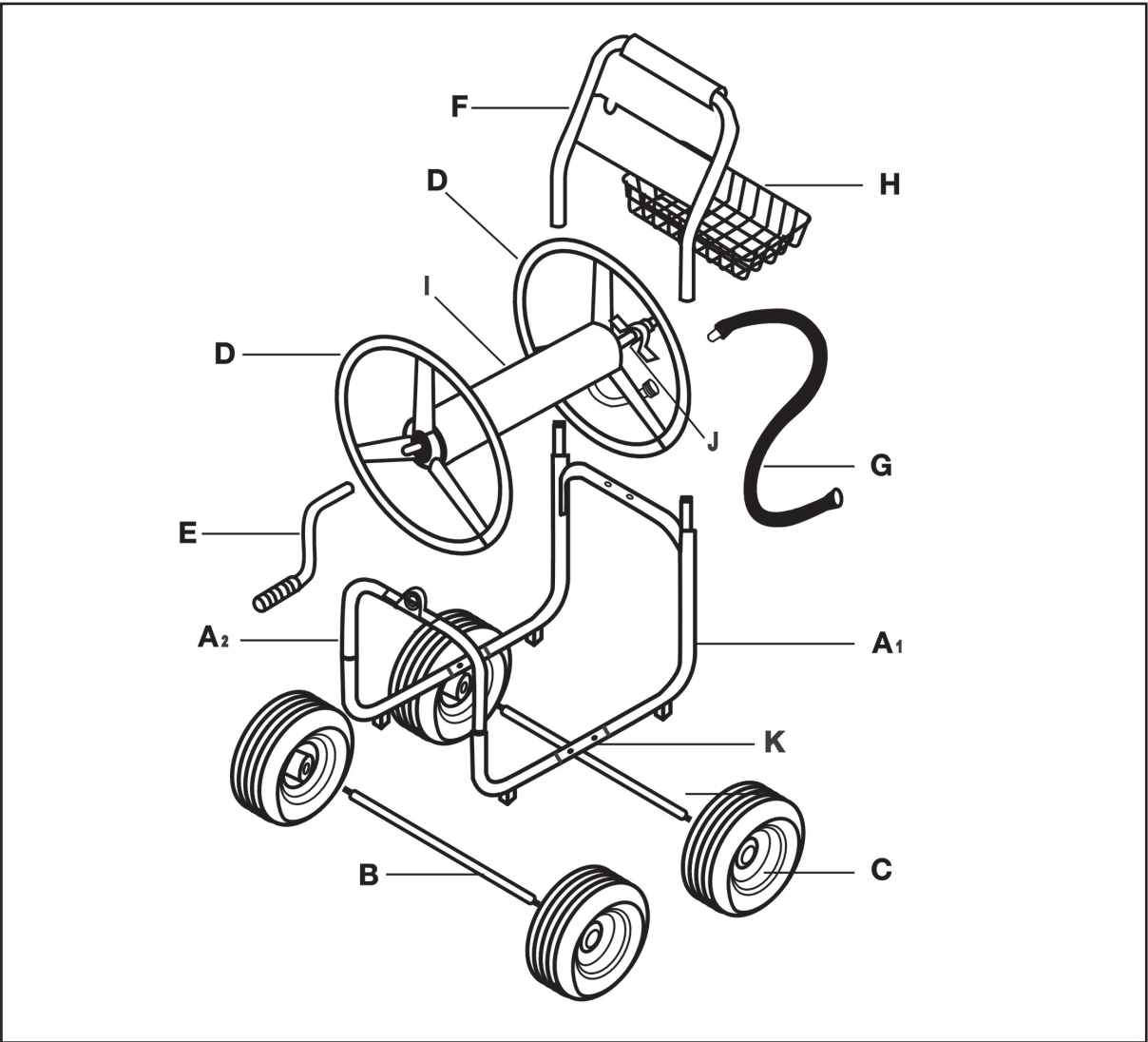

DIAGRAM & PARTS LIST

PARTS LIST		
PART #	DESCRIPTION	QUANTITY
A1 A2	Frame	2
B	Axles	2
C	Wheels	4
D	Hose Reel	2
E	Crank Handle	1
F	Handle	1
G	Leader Hose	1
H	Accessories Basket	1
I	Roller	1
J	Water Coupling	1
K	Support Bracket	4



PARTS LIST		
PART #	DESCRIPTION	QUANTITY
1	Carriage Bolt, 6x35mm	2
2	Carriage Bolt, 6x42mm	4
3	Bolt, 6x26mm	2
4	Bolt, 8x45mm	2
5	Bolt, 5x15mm	13
6	Bolt, 6x45mm	4
7	Hex Nut, 8mm	2
8	Flat Washer, 8mm	2
9	Lock Nut, 12mm	4
10	Flat Washer, 12mm	4
11	Lock Nut, 6mm	10
12	Flat Washer, 6mm	10
13	U Bracket	1
14	Rubber Washer (Includes 1-Square Rubber Washer)	2

Carefully remove the contents from the package. If any parts are missing do not attempt to use the product until they have been obtained and correctly installed.

The proportion of the following bolt, nut and flat washer to material object is 1 :1.

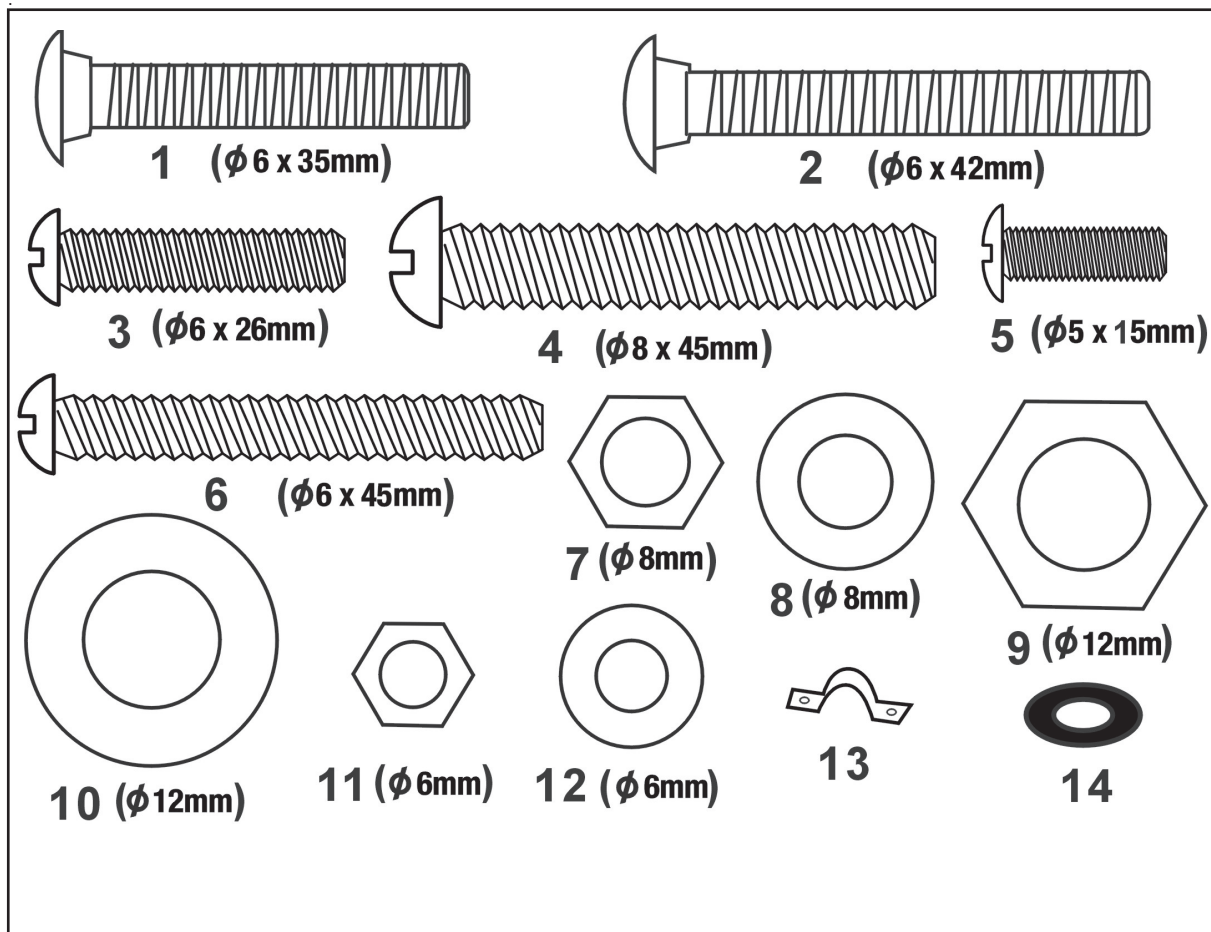



LivingScape™ is a trademark of Mid-States Distributing, LLC. © Mid-States Distributing, LLC.
Manufactured for and distributed by Mid-States Distributing, LLC Fort Worth, TX 76137 USA.
For questions or comments please call 888-376-7375.